

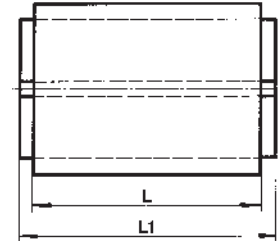

Rubber Suspension Unit

Type DR-A

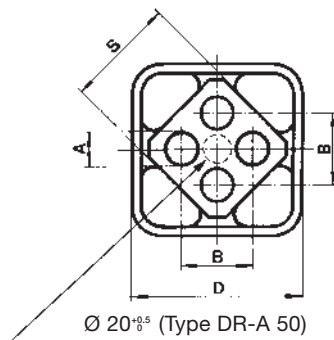
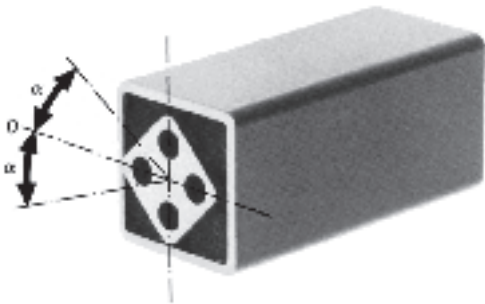

| Art. No. | Type | L | L1- $\varnothing_{0.3}$ | A $^{+0.5}$ | B | D | S | Torque M in Nm at α | | | | | | Weight in kg |
|------------|---------------|-----|-------------------------|-------------|-----------------|----------------------|----|----------------------------|-------|-------|--------|--------|--------|--------------|
| | | | | | | | | 5° | 10° | 15° | 20° | 25° | 30° | |
| 01 011 001 | DR-A 15 x 25 | 25 | 30 | 5 | 10 $^{\pm 0.2}$ | 27 $^{+0.2}_{-0.1}$ | 15 | 0.7 | 1.6 | 2.6 | 4.0 | 5.7 | 8.2 | 0.06 |
| 01 011 002 | DR-A 15 x 40 | 40 | 45 | 5 | 10 $^{\pm 0.2}$ | 27 $^{+0.2}_{-0.1}$ | 15 | 1.1 | 2.5 | 4.2 | 6.4 | 9.2 | 13.2 | 0.10 |
| 01 011 003 | DR-A 15 x 60 | 60 | 65 | 5 | 10 $^{\pm 0.2}$ | 27 $^{+0.2}_{-0.1}$ | 15 | 1.6 | 3.8 | 6.3 | 9.6 | 13.8 | 19.8 | 0.15 |
| 01 011 004 | DR-A 18 x 30 | 30 | 35 | 6 | 12 $^{\pm 0.3}$ | 32 $^{+0.1}_{-0.2}$ | 18 | 1.9 | 4.5 | 7.5 | 11.0 | 15.0 | 20.6 | 0.10 |
| 01 011 005 | DR-A 18 x 50 | 50 | 55 | 6 | 12 $^{\pm 0.3}$ | 32 $^{+0.1}_{-0.2}$ | 18 | 3.2 | 7.5 | 12.5 | 18.3 | 25.0 | 34.4 | 0.16 |
| 01 011 006 | DR-A 18 x 80 | 80 | 85 | 6 | 12 $^{\pm 0.3}$ | 32 $^{+0.1}_{-0.2}$ | 18 | 5.1 | 12.0 | 20.0 | 29.3 | 40.0 | 55.0 | 0.25 |
| 01 011 007 | DR-A 27 x 40 | 40 | 45 | 8 | 20 $^{\pm 0.4}$ | 45 $^{+0.2}_{-0.1}$ | 27 | 4.7 | 10.7 | 17.5 | 26.9 | 39.5 | 57.0 | 0.25 |
| 01 011 008 | DR-A 27 x 60 | 60 | 65 | 8 | 20 $^{\pm 0.4}$ | 45 $^{+0.2}_{-0.1}$ | 27 | 7.0 | 16.0 | 26.3 | 40.3 | 59.3 | 85.5 | 0.36 |
| 01 011 009 | DR-A 27 x 100 | 100 | 105 | 8 | 20 $^{\pm 0.4}$ | 45 $^{+0.2}_{-0.1}$ | 27 | 11.7 | 26.7 | 43.8 | 67.2 | 98.8 | 142.5 | 0.60 |
| 01 011 010 | DR-A 38 x 60 | 60 | 70 | 10 | 25 $^{\pm 0.4}$ | 60 $^{+0.15}_{-0.3}$ | 38 | 13.0 | 30.4 | 50.6 | 78.0 | 113.0 | 162.0 | 0.60 |
| 01 011 011 | DR-A 38 x 80 | 80 | 90 | 10 | 25 $^{\pm 0.4}$ | 60 $^{+0.15}_{-0.3}$ | 38 | 17.3 | 40.5 | 67.5 | 104.0 | 151.0 | 216.0 | 0.79 |
| 01 011 012 | DR-A 38 x 120 | 120 | 130 | 10 | 25 $^{\pm 0.4}$ | 60 $^{+0.15}_{-0.3}$ | 38 | 26.0 | 60.8 | 101.2 | 156.0 | 226.0 | 324.0 | 1.16 |
| 01 011 013 | DR-A 45 x 80 | 80 | 90 | 12 | 35 $^{\pm 0.5}$ | 72 $^{+0.15}_{-0.3}$ | 45 | 27.6 | 62.4 | 104.0 | 160.0 | 222.0 | 320.0 | 1.00 |
| 01 011 014 | DR-A 45 x 100 | 100 | 110 | 12 | 35 $^{\pm 0.5}$ | 72 $^{+0.15}_{-0.3}$ | 45 | 34.5 | 78.0 | 130.0 | 200.0 | 278.0 | 400.0 | 1.22 |
| 01 011 015 | DR-A 45 x 150 | 150 | 160 | 12 | 35 $^{\pm 0.5}$ | 72 $^{+0.15}_{-0.3}$ | 45 | 51.8 | 117.0 | 195.0 | 300.0 | 420.0 | 600.0 | 1.83 |
| 01 011 016 | DR-A 50 x 120 | 120 | 130 | M12x40 | 40 $^{\pm 0.5}$ | 78 $^{+0.15}_{-0.3}$ | 50 | 51.0 | 133.0 | 250.0 | 395.0 | 570.0 | 780.0 | 1.80 |
| 01 011 017 | DR-A 50 x 200 | 200 | 210 | M12x40 | 40 $^{\pm 0.5}$ | 78 $^{+0.15}_{-0.3}$ | 50 | 102.0 | 260.0 | 475.0 | 745.0 | 1070.0 | 1450.0 | 3.00 |
| 01 011 018 | DR-A 50 x 300 | 300 | 310 | M12x40 | 40 $^{\pm 0.5}$ | 78 $^{+0.15}_{-0.3}$ | 50 | 150.0 | 385.0 | 700.0 | 1100.0 | 1590.0 | 2160.0 | 4.47 |

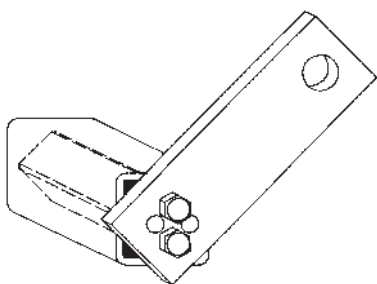

Bolted Lever Arm on Inner Square

Connection by means of 2 or 4 shaft screws across the inner square profile; or by means of set screws directly on the square profile (the customer-side thread tapping is required).